

LEGEND

 PROPOSED STREETS COVERED WITHIN THE 20MPH ZONE

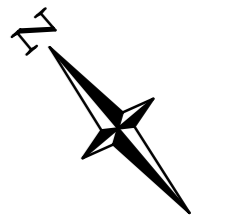
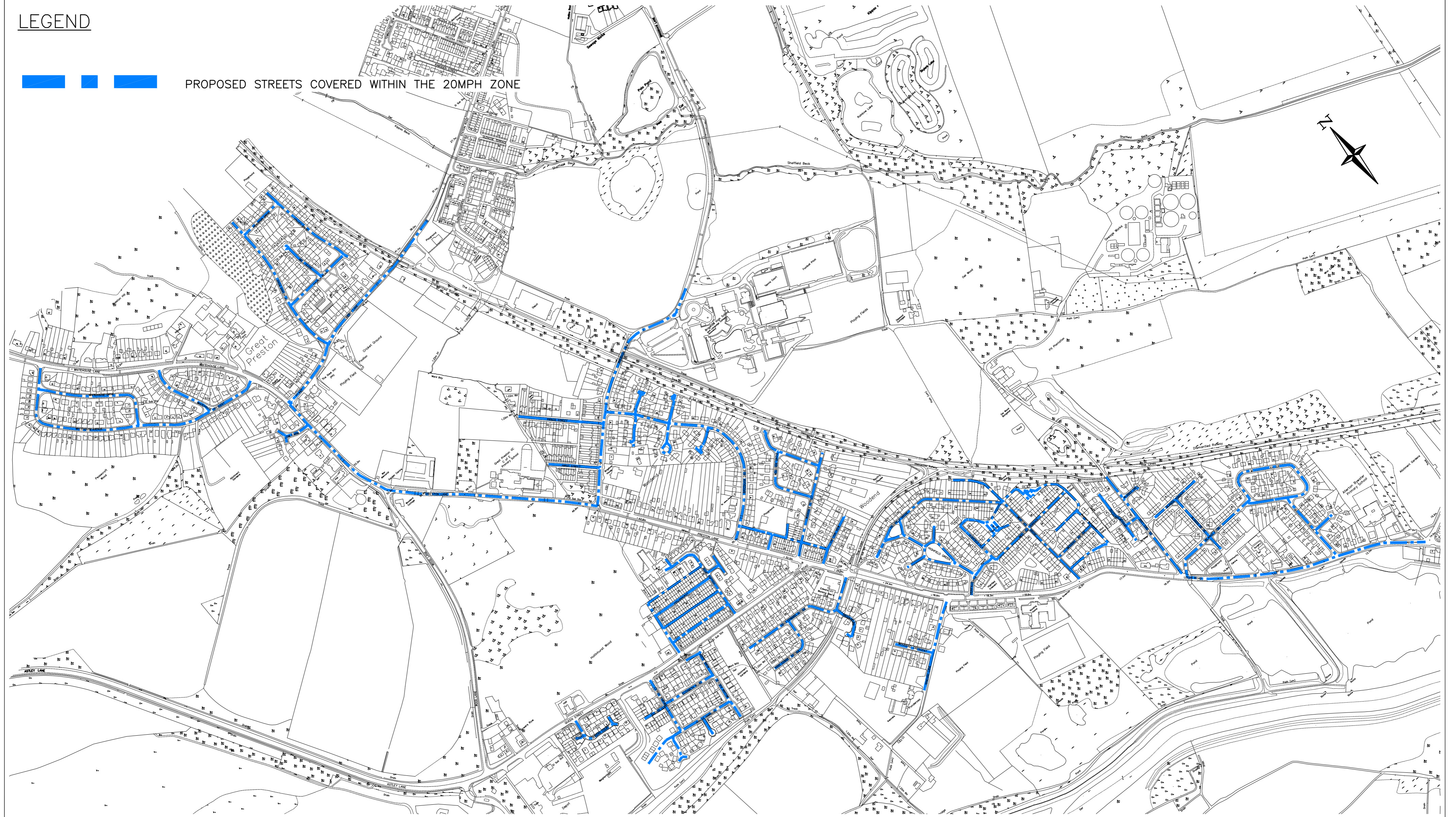

**PROPOSED 20mph ZONE
PRESTON LANE/ LEEDS ROAD
WARD:...GARFORTH & SWILLINGTON AND KIPPAX & METHLEY
(TRAFFIC REGULATION)(SPEED LIMIT)(N°19) ORDER 2015**

FIRST APPROVED	CP		
AMENDMENTS	DRAWN	CHECK	DATE

DRAWN BY		SCALE
INITIALS	DATE	N.T.S
CP	7/15	
AutoCAD BY		ORIGINAL SHEET SIZE
INITIALS	DATE	
CP	7/15	A2
CHECKED BY		
INITIALS	DATE	



Leeds
CITY COUNCIL
HIGHWAYS AND TRANSPORTATION

DRAWING NUMBER:
TM/21/2218/12/01
DATE: July 2015