

GENERAL NOTES

1. ALL WORK SHALL BE IN ACCORDANCE WITH THE CURRENT EDITIONS OF THE NATIONAL BUILDING REGULATIONS AND THE NATIONAL FIRE PROTECTION ASSOCIATION (NFPA) 101, LIFE SAFETY CODE.
2. ALL WORK SHALL BE IN ACCORDANCE WITH THE CURRENT EDITIONS OF THE NATIONAL BUILDING REGULATIONS AND THE NATIONAL FIRE PROTECTION ASSOCIATION (NFPA) 101, LIFE SAFETY CODE.
3. ALL WORK SHALL BE IN ACCORDANCE WITH THE CURRENT EDITIONS OF THE NATIONAL BUILDING REGULATIONS AND THE NATIONAL FIRE PROTECTION ASSOCIATION (NFPA) 101, LIFE SAFETY CODE.
4. ALL WORK SHALL BE IN ACCORDANCE WITH THE CURRENT EDITIONS OF THE NATIONAL BUILDING REGULATIONS AND THE NATIONAL FIRE PROTECTION ASSOCIATION (NFPA) 101, LIFE SAFETY CODE.
5. ALL WORK SHALL BE IN ACCORDANCE WITH THE CURRENT EDITIONS OF THE NATIONAL BUILDING REGULATIONS AND THE NATIONAL FIRE PROTECTION ASSOCIATION (NFPA) 101, LIFE SAFETY CODE.
6. ALL WORK SHALL BE IN ACCORDANCE WITH THE CURRENT EDITIONS OF THE NATIONAL BUILDING REGULATIONS AND THE NATIONAL FIRE PROTECTION ASSOCIATION (NFPA) 101, LIFE SAFETY CODE.
7. ALL WORK SHALL BE IN ACCORDANCE WITH THE CURRENT EDITIONS OF THE NATIONAL BUILDING REGULATIONS AND THE NATIONAL FIRE PROTECTION ASSOCIATION (NFPA) 101, LIFE SAFETY CODE.
8. ALL WORK SHALL BE IN ACCORDANCE WITH THE CURRENT EDITIONS OF THE NATIONAL BUILDING REGULATIONS AND THE NATIONAL FIRE PROTECTION ASSOCIATION (NFPA) 101, LIFE SAFETY CODE.
9. ALL WORK SHALL BE IN ACCORDANCE WITH THE CURRENT EDITIONS OF THE NATIONAL BUILDING REGULATIONS AND THE NATIONAL FIRE PROTECTION ASSOCIATION (NFPA) 101, LIFE SAFETY CODE.
10. ALL WORK SHALL BE IN ACCORDANCE WITH THE CURRENT EDITIONS OF THE NATIONAL BUILDING REGULATIONS AND THE NATIONAL FIRE PROTECTION ASSOCIATION (NFPA) 101, LIFE SAFETY CODE.

EXTERNAL LEGEND

AREA WHERE EXTERNAL FURNITURE WILL TAKE PLACE

AREA WHERE EXTERNAL FURNITURE WILL TAKE PLACE

AREA WHERE EXTERNAL FURNITURE WILL TAKE PLACE

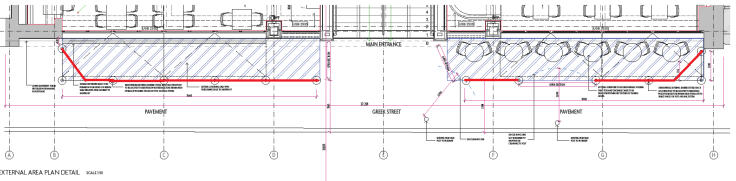
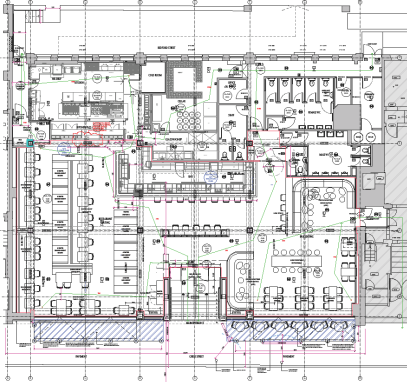
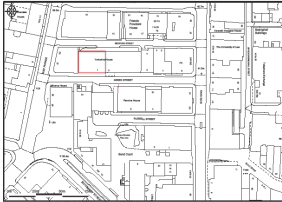

EXTERNAL TABLES

EXTERNAL TABLES SHALL BE IN ACCORDANCE WITH THE CURRENT EDITIONS OF THE NATIONAL BUILDING REGULATIONS AND THE NATIONAL FIRE PROTECTION ASSOCIATION (NFPA) 101, LIFE SAFETY CODE.

YSLETA EXTERNAL STACKABLE CHAIR

YSLETA EXTERNAL STACKABLE CHAIR SHALL BE IN ACCORDANCE WITH THE CURRENT EDITIONS OF THE NATIONAL BUILDING REGULATIONS AND THE NATIONAL FIRE PROTECTION ASSOCIATION (NFPA) 101, LIFE SAFETY CODE.



POST AND FABRIC BARRIER SYSTEM

POST AND FABRIC BARRIER SYSTEM SHALL BE IN ACCORDANCE WITH THE CURRENT EDITIONS OF THE NATIONAL BUILDING REGULATIONS AND THE NATIONAL FIRE PROTECTION ASSOCIATION (NFPA) 101, LIFE SAFETY CODE.

FABRIC BARRIER SYSTEM

FABRIC BARRIER SYSTEM SHALL BE IN ACCORDANCE WITH THE CURRENT EDITIONS OF THE NATIONAL BUILDING REGULATIONS AND THE NATIONAL FIRE PROTECTION ASSOCIATION (NFPA) 101, LIFE SAFETY CODE.

NO.	DATE	REVISION
1	03/06/18	ISSUED FOR PERMIT
2	03/06/18	ISSUED FOR PERMIT
3	03/06/18	ISSUED FOR PERMIT

PROJECT	3336
DATE	03/06/18

Macaulay
Stratton

CONSTRUCTION

144 3336 ST 03/06/18 3336
144 3336 ST 03/06/18 3336
144 3336 ST 03/06/18 3336