

Appendix A: Affected properties and location of the sites

The affected properties are:

- 1-61 Alderton Heights, Leeds LS17 5LU – containing 60 flats
- 62-121 Alderton Heights, Leeds LS17 5LT – containing 60 flats
- 122-181 Alderton Heights, Leeds LS17 5LS – containing 60 flats
- 46 garages Alderton Heights

- 1-61 Gipton Gate West, Leeds LS9 6BZ – containing 60 flats
- 6 garages Gipton Gate West

- 62-121 Gipton Gate East, Oak Tree Drive, Leeds LS9 6SU – containing 60 flats
- 6 garages Gipton Gate East

Alderton Heights, Moortown Leeds LS17

The Alderton Heights site in Alwoodley contains 180 flats in three high rise blocks, with 46 associated garages. It is a relatively narrow landscaped site (c 1.75 ha) adjoining a large sloping area of open land to the southern end. The site slopes away from Scotland Wood Road and adjoins a steeply sloping wooded embankment down to Meanwood/Adel beck.

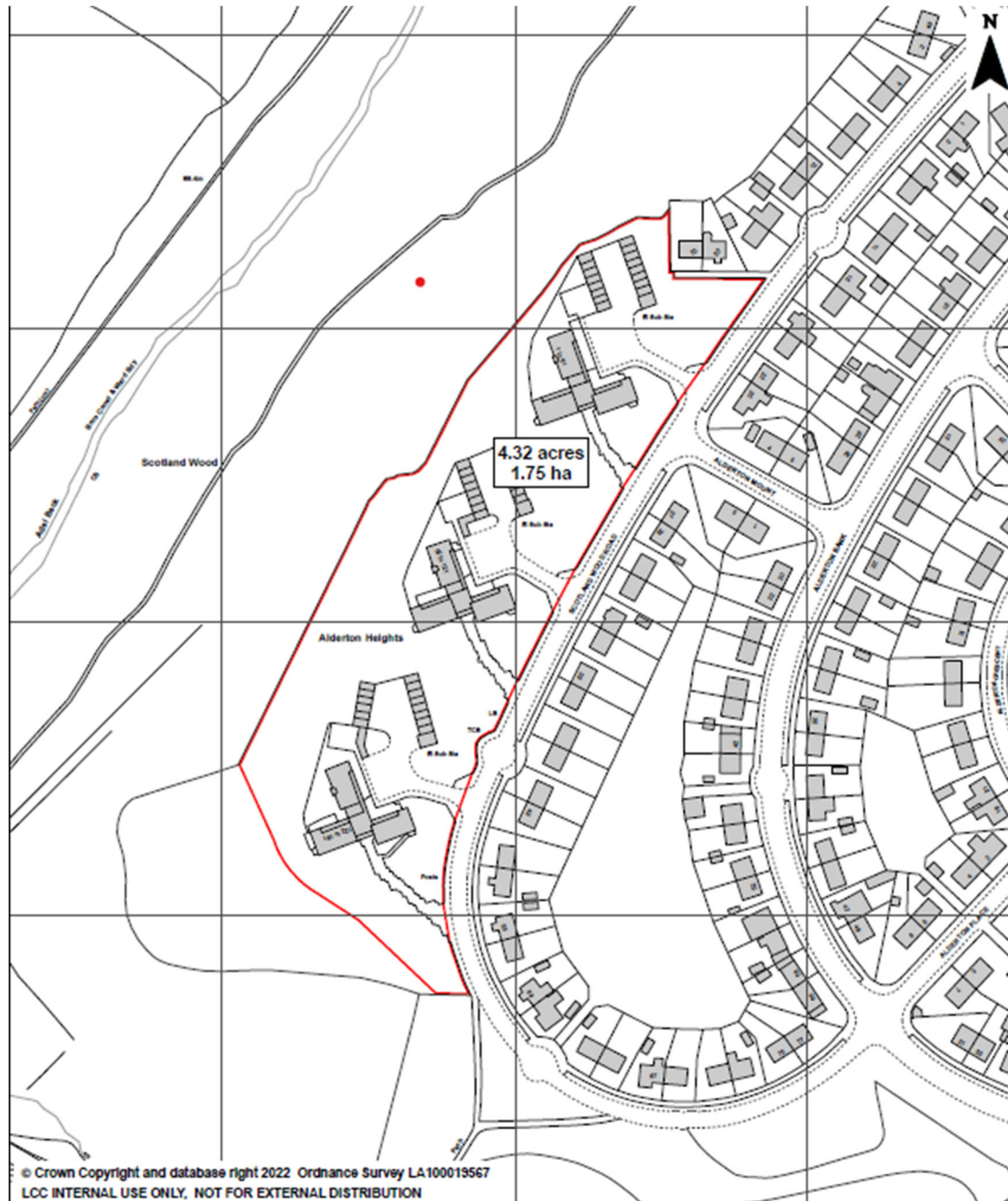

You are not permitted to copy, sub-licence, distribute or sell any of this data to third parties in any form.
Produced by Land Records, City Development, Leeds City Council

0 12.5 25 50 75 100 Metres

PREP BY M. CHRISTIAN
DATE SAVED: 26/08/2022
OS No: SE2838
SCALE @ A3 1:1,250

PLAN No 21513/A

Gipton Gates, Leeds LS9

The Gipton Gate West site in Gipton contains 60 flats in one block with 6 associated garages. It is significantly constrained but relatively level site (c0.31 ha) with little land surrounding.

The Gipton Gate East site also contains 60 flats in one block with 6 associated garages. The block and garages are on a plateau surrounding by a significant open grassed area, with steep embankments (c0.53 ha).

Adjacent and to the east of the site is a further garage court set at a lower level with separate access, with a retaining structure between the two levels. Next to this is Briarsdale Heights, another council high rise block.

